

Kuparuk Transportation Company

P.O. BOX 100360
ANCHORAGE, ALASKA 99510-0360
Telephone (907) 263-3700
Facsimile (907) 263-3748

Karen L. Kennedy
Operations and Engineering Manager
907.263.3741

08 November 2006

Mr. Tom Manson
Senior Environmental Coordinator
ConocoPhillips Alaska, Inc.
P. O. Box 100360
Anchorage, Alaska 99510-0360

Re: **Non-Objection for Installation of Two 3-inch Diesel Pipelines**
Kuparuk Pipeline ADL 402294
Kuparuk Pipeline Extension ADL 409027

Dear Mr. Manson:

ConocoPhillips Alaska, Inc. requested a Letter of Non-Objection to install two 3-inch diesel pipelines within the Kuparuk Pipeline (KPL) and Kuparuk Pipeline Extension (KPE) Rights-of-Way (ROW) at Central Processing Facility Number 1 (CPF1). It is our understanding that work will be conducted near or within the ROW along the south and west sides of the CPF1 pad during the first and second quarter of 2008. The new pipelines in this area will be mounted on the existing in-field 24-inch seawater pipeline racks and supports. A formal written lifting plan will be developed once the construction contractor is selected.

Kuparuk Transportation Company (KTC) and our Operator have reviewed your 30 October 2006 request. Our evaluation has concluded that the proposed work is compatible with the continued safe operations of the KPL and KPE and poses no integrity concerns. As such, KTC has no objection to the access of or work within the ROW.

Since this is a 2008 project, please provide KTC the following:

- A summary level progress report by 31 December of each year until the work within the ROW is complete.
- A copy of the formal written lifting plan for review when available.
- 30-days notice prior to initiating work within the ROW.
- Notice when the work within the ROW is complete.
- Notice of any significant project delays or scope changes.

When working within the ROW, please plan on coordinating daily permitting and a final ROW inspection through the NSK Pipeline Coordinators at 907-659-7574.

Please contact Sara Pate at 907-263-3738 or myself if you have questions or require additional information.

Sincerely,



Karen Kennedy
Operations and Engineering Manager

Attachments

cc:

CPF1 Production Superintendent	NSK 6	w/o attachment
NSK Pipeline Coordinator	NSK 22	
NSOD Pipeline Operations Supervisor	NSK 22	
Van Lineberger	NSK 54	w/o attachment
Barbara Fullmer	ATO 2084	w/o attachment
Darren Jones	ATO 2100	w/o attachment
Sara Pate	ATO 992	
Sherry Timmerman	ATO 902	
James Calaway	ATO 1063	w/o attachment
Don Schreiner	ATO 888	w/o attachment
Scott Pexton	SPCO	
Mike Thompson	SPCO	w/o attachment



Tom Manson
Senior Environmental Coordinator
Post Office Box 100360
Anchorage, Alaska 99510-0360
Phone (907) 263-4627
Fax: (907) 263-4035
Email: Tom.W.Manson@conocophillips.com

October 30, 2006

Ms. Sara Pate
ConocoPhillips Alaska Pipelines
P.O. Box 100360
Anchorage, Alaska 99510

Re: Request for Letter of Non-Objection
Ultra Low Sulfur Pipeline

Dear Ms. Pate:

ConocoPhillips Alaska, Inc. (CPA) requests a letter of non-objection to install two 3-inch pipelines within the Kuparuk Pipeline Right-of-Way (ROW) at the Kuparuk Central Processing Facility Number 1 (CPF-1). One pipeline will transport high sulfur diesel (HSD) from the Diesel Storage and Distribution Facility at CPF-1 to the proposed Ultra Low Sulfur Diesel facility at CPF-3. Here the HSD will be processed into ultra low sulfur diesel (ULSD). The second pipeline will carry the ULSD back to the Storage and Distribution facility.

The pipelines will start at the Diesel Storage and Distribution Facility, located on the south side of the CPF-1 pad. Here the pipelines will enter the Kuparuk Pipeline ROW, and follow the ROW (using the existing pipe rack) along the south and west sides of the CPF-1 pad. At the northwest corner of the CPF-1 pad the pipelines will leave the Kuparuk Pipeline ROW, crossing the Spine Road and then running west along the north side of the road, mounted on the 24-inch seawater pipeline racks and supports. At the intersection of the Oliktok and Spine Roads the pipelines will cross over the road and be mounted on the existing 30-inch seawater pipeline supports and travel north along the side of the Oliktok Road to CPF-3 where they will tie-in to the ULSD Facility.

With the exception of the section around the south and west sides of the CPF-1 pad, all pipelines and construction activities are outside of the Kuparuk Pipeline ROW.

These pipelines are in support of the Ultra Low Sulfur Diesel Project and include the following activities near or within the Kuparuk Pipeline ROW:

- Construction of ice roads along the south and west sides of CPF-1;
- Installation of vertical and horizontal support members as required;
- Pipe stringing;
- Pipe welding;
- Field coating installation;
- Pipe inspections;
- Raise-up and tie-ins;
- Wind Induced Vibration dampener installation, as needed;
- Hydrotesting;

The attached drawings provide further construction and alignment details.

A formal written lifting plan is required prior to commencing construction. This plan will be completed after a contractor has been selected for the work.

CPAI is requesting a letter of non-objection from ConocoPhillips Alaska Pipelines for these activities within the Kuparuk Pipeline ROW. CPAI believes that this work will not have any adverse effects on the Kuparuk pipelines.

If you have any questions or need additional information, please contact me at (907) 263-4627.

Sincerely,



Thomas Manson
Senior Environmental Coordinator

Attachments

cc: D. Schreiner ATO-888
Reader File
PC Docs

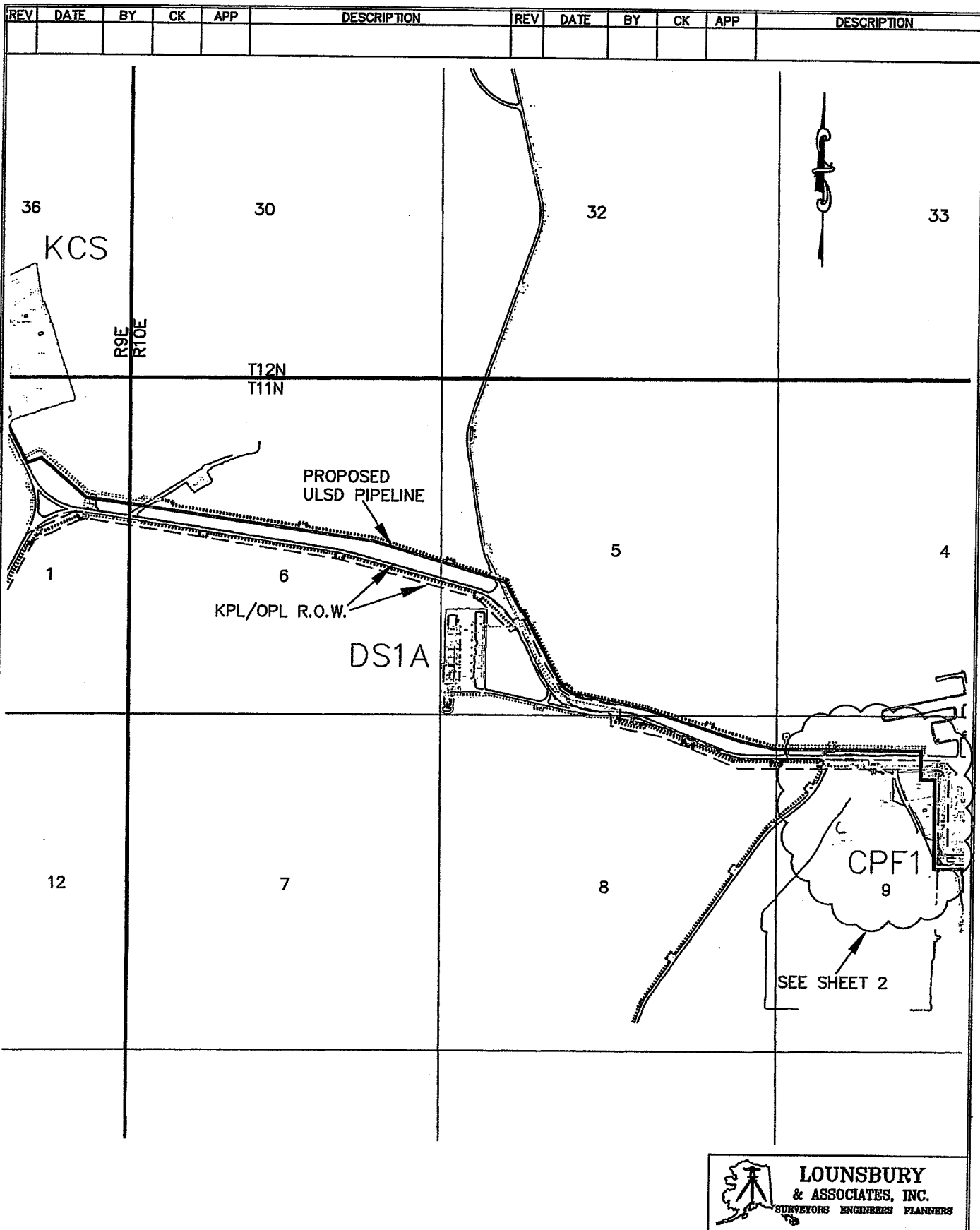

ConocoPhillips
 Alaska, Inc.

AREA: _____ MODULE: XXXX UNIT: _____
 CPF3 TO CPF1
 ULSD PIPELINE
 PERMIT EXHIBIT

CADD FILE NO.
LK610D49

10/26/06

DRAWING NO:

NSK 6.10-d49

PART:
3 OF 4

REV:
0



REV	DATE	BY	CK	APP	DESCRIPTION	REV	DATE	BY	CK	APP	DESCRIPTION
-----	------	----	----	-----	-------------	-----	------	----	----	-----	-------------

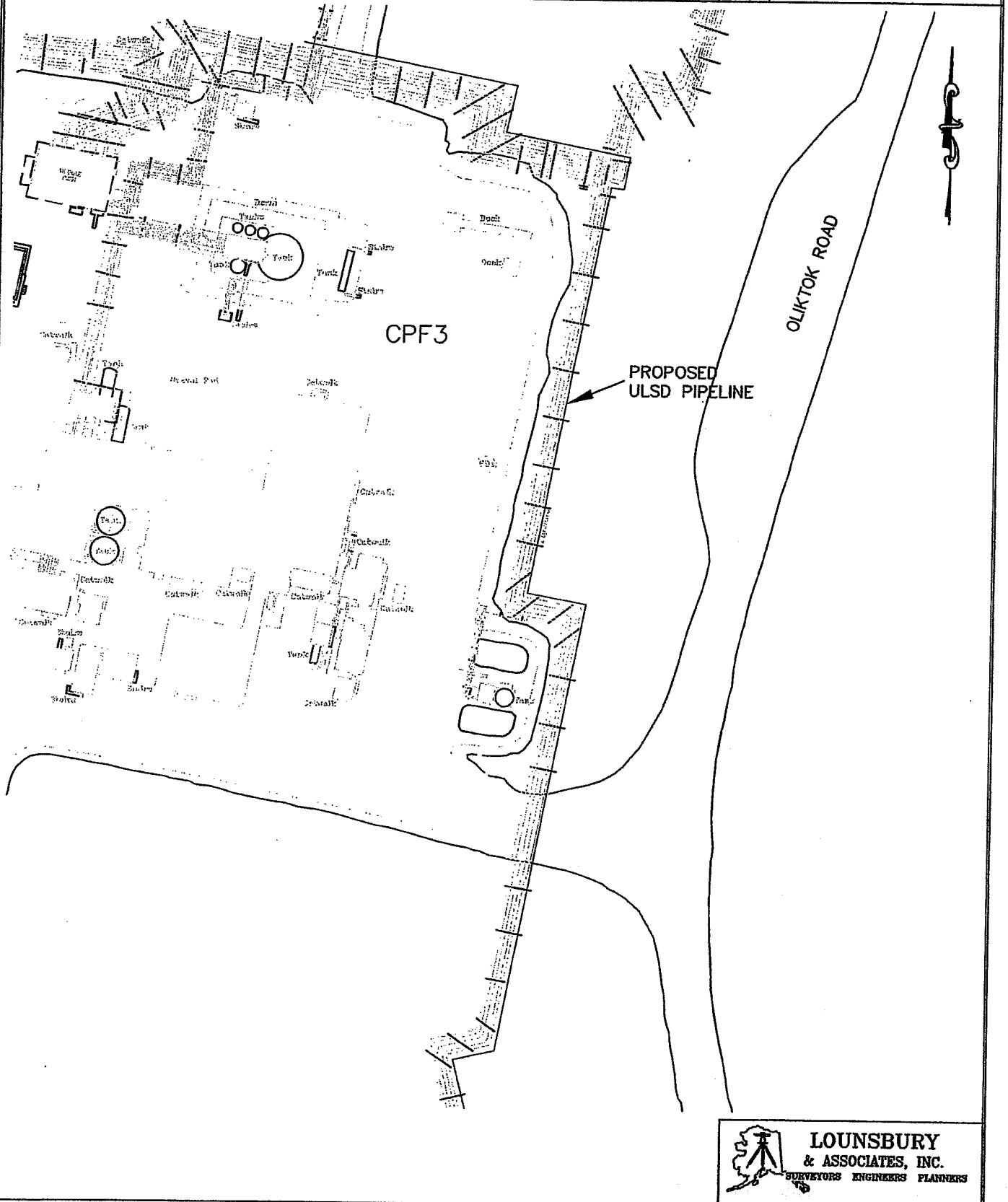

ConocoPhillips
Alaska, Inc.

AREA: MODULE: XXXX UNIT:
CPF3 TO CPF1
ULSD PIPELINE
PERMIT EXHIBIT

CADD FILE NO.
LK610D49

10/26/06

DRAWING NO:

NSK 6.10-d49

PART:
4 OF 4

REV:
0